

# Lubricator AL200 Series

Symbol

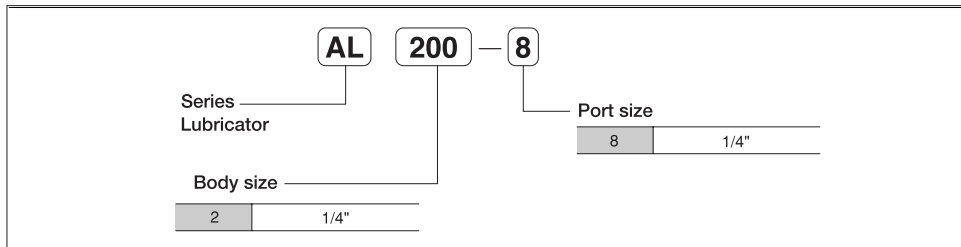

## ORDER KEY



## Specifications

Model No	Unit	AL320	AL420
Port size		Rc 3/8"	Rc 1/2"
Gauge port		Rc 1/8	
Fluid	MPa (bar)	Air	
Proof pressure	MPa (bar)	1.5 (15.0)	
Max supply pressure	MPa (bar)	1.0 (10.0)	
Temperature range	°C	0 ~ 60	
Lubrication		Turbin #1 (ISO VG32)	

## Flow Characters

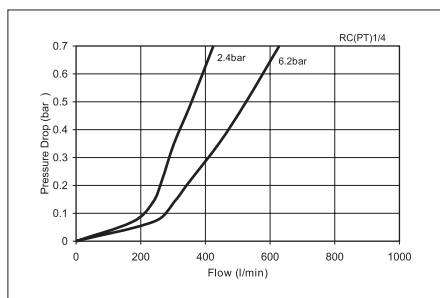

## Dimensions

(Unit : mm)

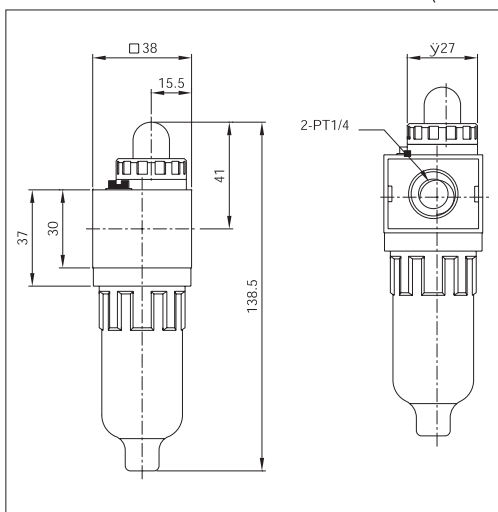

# Lubricator AL320, AL420 Series

Symbol



## ORDER KEY

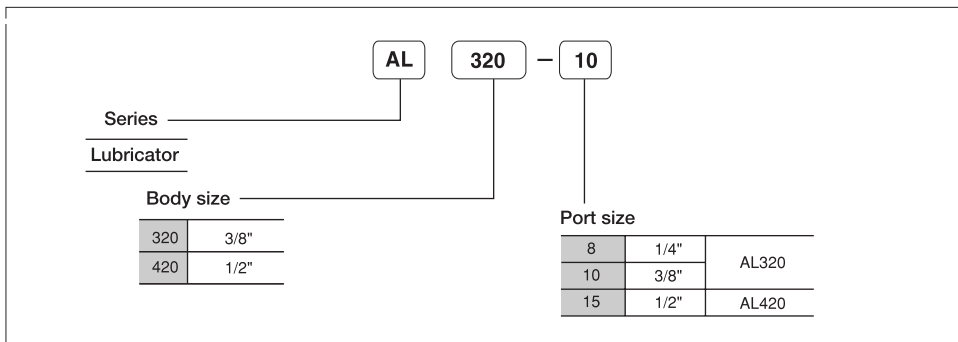

## Specifications

Model No	Unit	AL320	AL420
Port size		Rc(PT)1/4", 3/8"	Rc(PT)1/2"
Fluid		Air	
Proof pressure	MPa (Bar)	1.5 (15.0)	
Max supply pressure	MPa (Bar)	1.0 (10.0)	
Temperature range	°C	0~60	
Filter element		Turbin #1 (ISO VG32)	
Weight	g	300	424

## Component

No	Description	Material
1	Body	Aluminium
2	Trip Control Body	Brass / NBR
3	O-ring	NBR
4	Seal	NBR
5	Oil Cap	ABS
6	Knob	ABS
7	Bowl	ABS
8	Bowl O-ring	NBR
9	Bowl Guide	ABS

## Constructions

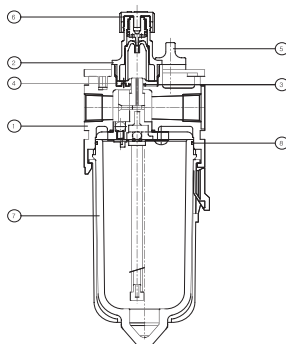

# Lubricator

## Flow Chart

AL320

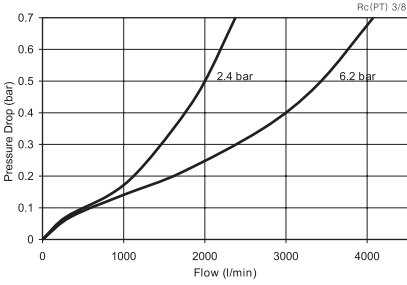

AL420

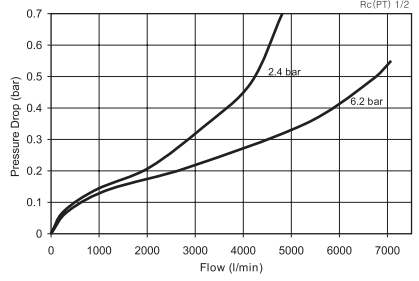

## Dimensions

(Unit : mm)

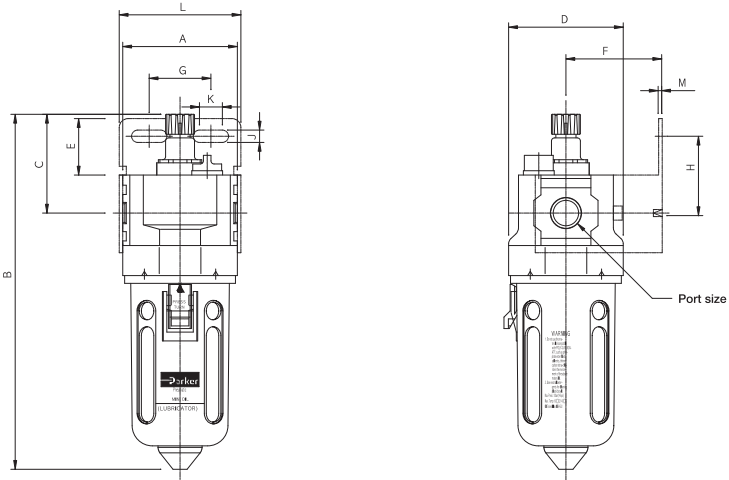

Model No	A	B	C	D	Mounting							
					E	F	G	H	J	K	L	M
AL320	65	198	56	65	32	50	35	45	7	13	69	2.3
AL420	80	216	56	80	32	50	50	45	7	13	85	2.3